

RUTHERFORD WEST, SECTION 2

SEABORN J. WHATLEY
SURVEY No. 22
ABST. No. 18

REMAINDER OF
MICHAEL GILES RUTHERFORD
FIRST TRACT
VOL. 197, PG. 45
H.C.D.R.

700.03 Ac.
JOHN RICHARD RUTHERFORD
VOL. 1214, PG. 548
H.C.D.R.

FRELOVE WOODY
SURVEY No. 23
ABST. No. 20

L.C.R.A.
30' WIDE R.O.W. ESMT.
V.254, P.218
H.C.D.R.

APPROXIMATE LOCATION
OF SURVEY LINE

0.2709 AC.
TEMPORARY TURNAROUND
EASEMENT
Vol. 2887 Pg.509
H.C.D.R.

177.762 Ac.
(EXHIBIT A-1)
LSM RANCH, LTD.
VOL. 1628, PG. 206
H.C.D.R.

APPROXIMATE LOCATION OF SURVEY LINE

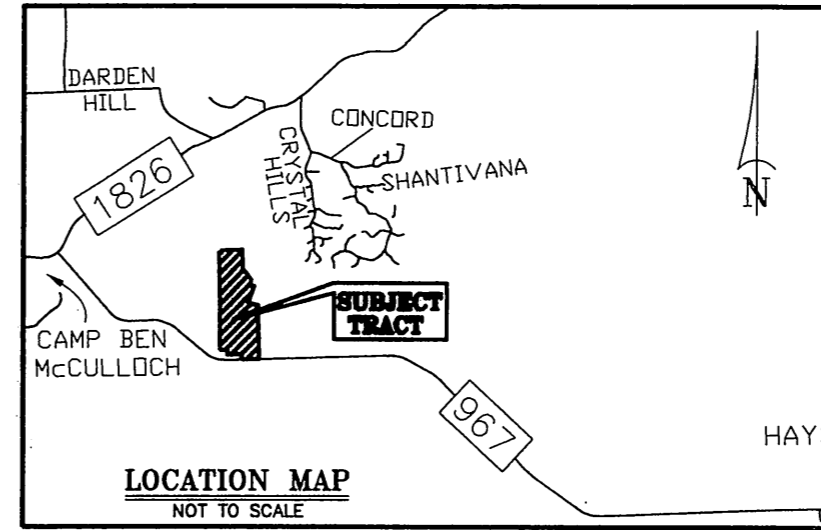
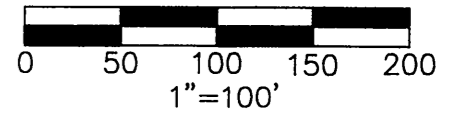

LEGEND

- O.P.R.H.C. OFFICIAL PUBLIC RECORDS HAYS COUNTY
- H.C.P.R. HAYS COUNTY PLAT RECORD
- H.C.D.R. HAYS COUNTY DEED RECORD
- U.S.F.W.S. U.S. FISH & WILDLIFE SERVICE
- BLDG. LN. BUILDING LINE
- R.O.W. RIGHT OF WAY
- P.U.E. PUBLIC UTILITY EASEMENT
- D.E. DRAINAGE EASEMENT
- W.Q.E. WATER QUALITY EASEMENT
- HIGHWAY R.O.W. MARKER FOUND (TYPE I)
- P.E.C. BRASS DISK IN CONC. FOUND
- 1/2" IRON ROD FOUND UNLESS OTHERWISE NOTED
- 1/2" IRON ROD SET WITH PLASTIC CAP MARKED "CAPITAL SURVEYING CO. INC."
- ⊙ 1/2" IRON ROD FOUND WITH PLASTIC CAP MARKED "CAPITAL SURVEYING CO. INC."
- ⊗ 1/2" IRON ROD FOUND WITH ALUMINUM CAP STAMPED "KEN McMILLAN LAND SURVEYOR, RPLS 4341"
- ⊠ FENCE CORNER POST FOUND
- ▲ CALCULATED POINT
- WATER QUALITY BUFFER ZONE
- U.S.F.W.S. SETBACK AND D.E.
- GREENBELT AND DRAINAGE EASEMENT IS THE AREA BEYOND (AWAY FROM) RIGHT-OF-WAY

577.094 Ac.
WFCRW LLC
Doc. No. 05018515
O.P.R.H.C.

GREGORIO ESPARZA
SURVEY FILE No. D-762
ABST. No. 169

SURVEYOR'S NOTES:

1. A PORTION OF THIS SUBDIVISION LIES WITHIN THE BOUNDARIES OF THE EDWARDS AQUIFER RECHARGE ZONE.
2. A PORTION OF THIS SUBDIVISION LIES WITHIN THE BOUNDARIES OF THE CONTRIBUTING ZONE OF THE BARTON SPRINGS SEGMENT OF THE EDWARDS AQUIFER.
3. NO PORTION OF THIS SUBDIVISION LIES WITHIN THE BOUNDARIES OF ANY MUNICIPALITY'S CORPORATE CITY LIMITS, BUT IS WITHIN THE EXTRATERRITORIAL JURISDICTION OF THE CITY OF DRIPPING SPRINGS.
4. THE STORMWATER RESULTING FROM THE 100 YEAR RAIN EVENT SHALL BE CONTAINED WITHIN THE DRAINAGE EASEMENTS SHOWN HEREON.
5. NO PORTION OF THIS SUBDIVISION LIES WITHIN THE BOUNDARIES OF THE 100 YEAR FLOOD PLAIN AS DELINEATED ON HAYS COUNTY COMMUNITY PANEL MAP #48209C0255 F, AND #48209C0140 F, EFFECTIVE DATE SEPTEMBER 2, 2005.

THAT I GREGORY A. WAY, A PROFESSIONAL LAND SURVEYOR IN THE STATE OF TEXAS, HEREBY CERTIFY THAT THIS PLAT COMPLIES WITH THE SURVEY RELATED REQUIREMENTS OF THE CITY OF DRIPPING SPRINGS SUBDIVISION ORDINANCE AND FURTHER CERTIFY THAT THIS PLAT IS TRUE AND CORRECTLY MADE AND IS PREPARED FROM AN ACTUAL SURVEY OF THE PROPERTY MADE UNDER MY SUPERVISION ON THE GROUND AND THAT THE CORNER MONUMENTS WERE PROPERLY PLACED UNDER MY SUPERVISION.

WITNESS MY HAND THIS THE 27th DAY OF February, 2006.

Gregory A. Way
GREGORY A. WAY
REGISTERED PROFESSIONAL LAND SURVEYOR
NO. 4567 - STATE OF TEXAS
CAPITAL SURVEYING COMPANY, INC.
1101 CAPITAL OF TEXAS HWY.
AUSTIN, TEXAS 78746



RUTHERFORD WEST, SECTION 2

CSCI		CAPITAL SURVEYING COMPANY, INC.	
1101 Capital of Texas Highway South Austin, Texas 78746		Building C, Suite 100 (512) 327-4006	
DRAWN BY: WAL	SCALE: 1" = 100'	F.B.	
JOB NO.: 05538.10	DATE: MAY 22, 2007	SHEET NO.:	
DRAWING NO.: 05538P2	CRD #: 05538	2 OF 5	

PHOTOGRAPHIC MYLAR

MATCHLINE
SEE SHEET 3 OF 5

MATCHLINE
SEE SHEET 3 OF 5